

Explosion Proof

Food Light



Materials

- ★ Housing: copper free aluminum
- ★ Lens: glass
- ★ Hardware: stainless steel
- ★ Mounting Bracket: stainless steel

Basic Data

Product Number	Wattage	Color Temperature	Voltage	Lumens	Working Hours	CRI
EX-20W B2YZDA-F	20	4000K-5700K	DC12-48V or DC250V	2800	5 years	70
EX-40W B2YZDA-F	40	4000K-5700K	AC100-277V (by driver or by IC)	5600	5 years	70
EX-60W BYZDA-F	60	4000K-5700K	DC12-48V or DC250V AC100-277V (by driver or by IC) AC200-480V (by driver)	8400	5 years	70
EX-80W BYZDA-F	80	4000K-5700K		11200	5 years	70
EX-100W B3YZDA-F	100	4000K-5700K		14000	5 years	70
EX-120W B3YZDA-F	120	4000K-5700K		16800	5 years	70
EX-150W B3YZDA-F	150	4000K-5700K		21000	5 years	70
EX-200W B3YZDA-F	200	4000K-5700K		28000	5 years	70

“B, B2, B3”=Product series “Y”=D or N:Dimmable or non-dimmable “Z”= CCT, from 4000~5700K “D”=Beam angle: 40°, 60°, 90°, 120°

Explosion Protection

Marking Atex	II3 G Ex ec IIB T3C Gc II2 Ex tb IIIC T160°C Db IP66
Marking IECEx	Ex ec IIB T3C GC Ex tb IIIC T160°C Db IP66
Marking UL844 (North American)	Class I, Division 2, Groups A, B, C, D Class II, Division 1, Groups E, F, G Class II, Division 2, Groups F, G Class III
Marine Marking	UL 1598A ABS Type Approved
Other Rating	IP 66 IK 10

Applications

Oil and Gas industry

- ★ All petroleum production and refining
- ★ Petroleum loading and transportation
- ★ Petroleum storage and retail
- ★ LNG industry
- ★ All mining operations and service

Chemical industry

- ★ All types of paint facilities
- ★ Chemical production and storage

Ocean, marine and aerospace field

- ★ Ocean platform operation facilities and structure
- ★ Aerospace clean room and production
- ★ Ocean vessel operations

Metal treatment

- ★ Steel and aluminum factories
- ★ Pumping stations in any environment
- ★ Metal smelting, foundry and fabrication

Food and alcohol industry

- ★ Flour and fine particle production and storage
- ★ Food and distilling production
- ★ alcohol industry

Other high humidity, high dust, high temperature, vapor locations

Key Features

- High quality SMT LED and Meanwell Driver.
- Light-weight design by aircraft aluminum.
- Heavy-duty and high impact resistance.
- Three connection cable entry points.
- Replaceable LED board and drivers.
- Integrated junction box for driver with emergency back up.
- Dimmable and battery back up function available.
- Marine rating powder coated appearance treatment.

Value-Added Features

- 10kV surge protection.
- Up to ten years limited warranty option.
- Emergency Battery back up to three hours .
- Working temperature can be more than 85°C.
- Various installation ways for different applications.
- Glass lens or Glass with polycarbonate lens to make bigger beam angle.

Mechanical Structure

Unit: mm or inch

B2 Series

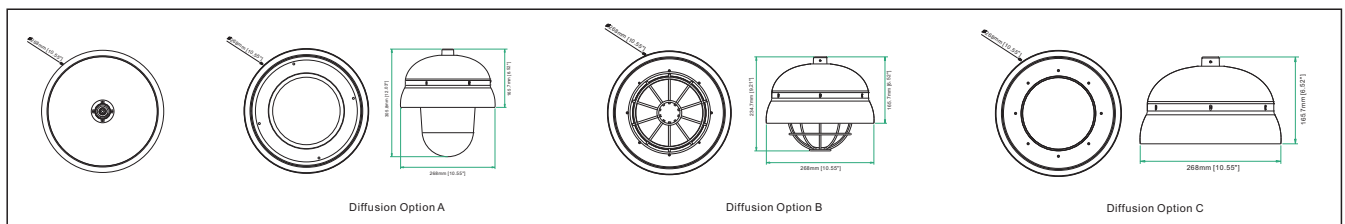

This structure type with bracket, flat glass and optics lens generates 40°, 60°, 90° and 120° light distribution.

B Series

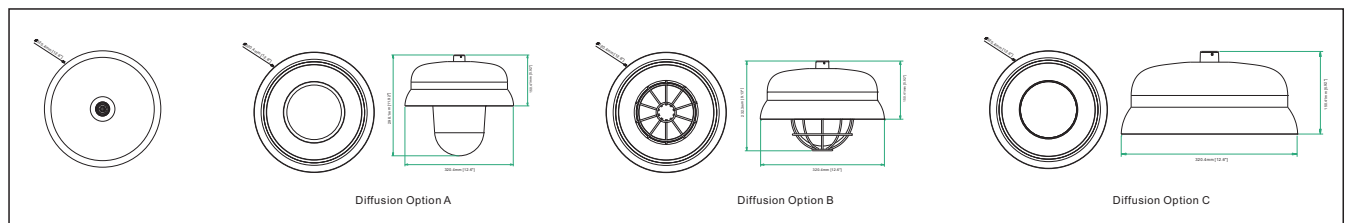

This structure type with bracket, flat glass and optics lens generates 40°, 60°, 90° and 120° light distribution.

B3 Series

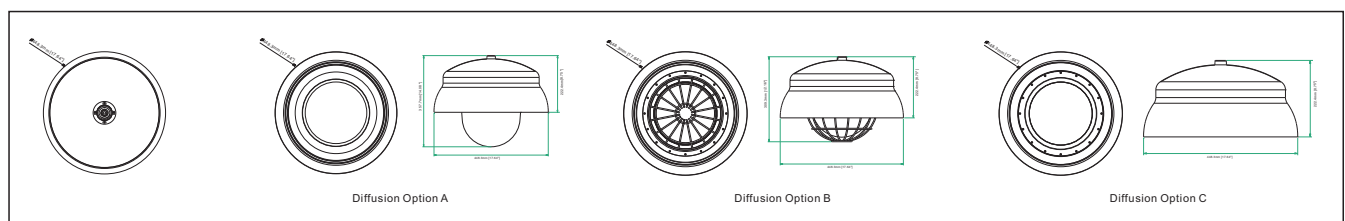

This structure type with bracket, flat glass and optics lens generates 40°, 60°, 90° and 120° light distribution.

Lighting Distribution

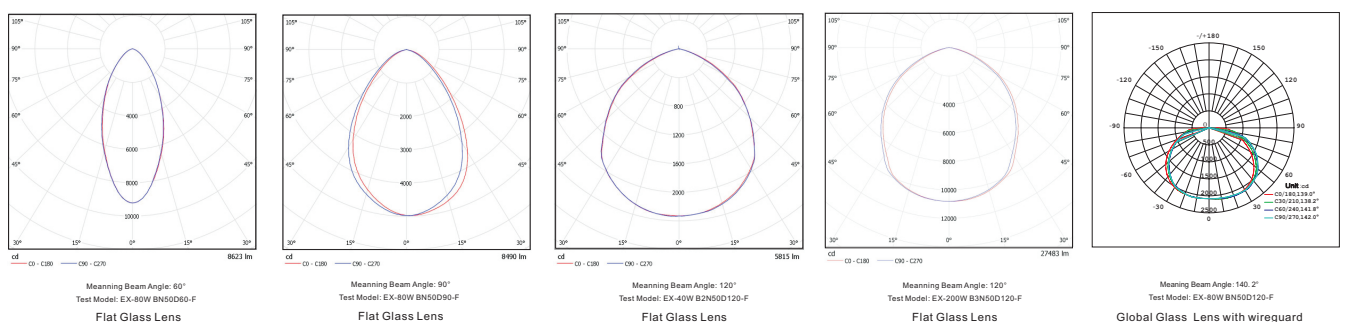

Installation Manual

WARNING

READ THIS INSTRUCTION CAREFULLY BEFORE INSTALLING. KEEP THIS INSTRUCTION FOR FUTURE REFERENCE.

Fixtures must be wired in accordance with the National electrical code and all applicable local codes. Proper grounding is required for safety.

THIS PRODUCT MUST BE INSTALLED IN ACCORDANCE WITH THE APPLICABLE INSTALLATION CODE BY A QUALIFIED ELECTRICIAN WHO IS FAMILIAR WITH THE CONSTRUCTION AND OPERATION OF THE PRODUCT AND THE HAZARDS INVOLVED.

Warning: Risk of fire or electric shock. High bay Light installation requires knowledge of luminaires and electrical systems. If not qualified, DO NOT try to install. Please contact an electrician.

Warning: Risk of fire or electric shock. Suitable for wet locations. Make sure the power is off prior to install.

Warning: Risk of fire or electric shock. Suitable for non-insulated surface and frame. DO NOT cover fixture with insulation liner or similar material.

Warning: DO NOT install in unstable, loose or breakable surfaces.

Warning: DO NOT let objects impact or exert force on the surface of the fixture.

Ceiling Mounting



WARNING
 Risk of fire, Electric shock or personal injury
 Before installation, turn off power!

Pole Pendant

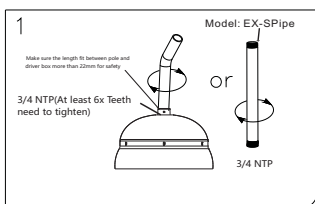

1. Take the fixture and pole accessory out from carton box, tighten pole as shown in Fig.1.

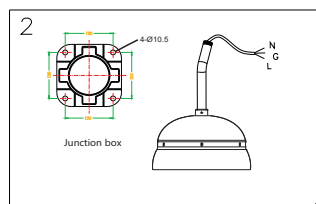

2. Connect black cable to L, Connect White cable to N, Connect green cable to grounding.

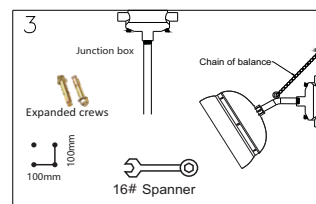

3. Drill 4x Ø10mm holes, as 100mm distance, install the junction box to the wall or ceiling as shown in Fig.3, tighten the pole to the box, and adjust the chain of balance.

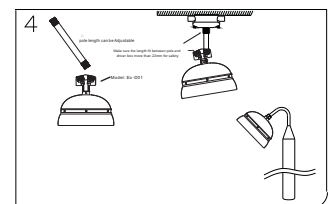

4. Adjustable pole installation. With this adjustable kit, you can Make any light distribution direct as you want. Optional: Install the fixture to the long pole after cable connecting cable.

Hook Pendant

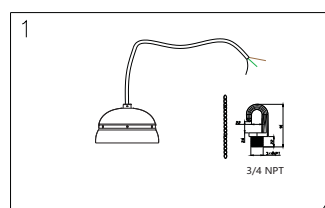

1. Take the fixture and accessory out from carton box, tighten 2x angle holder screw as Fig.1.

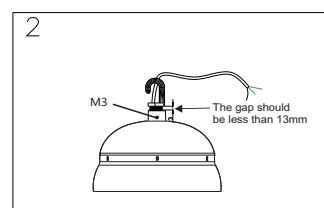

2. Tighten the hook with the fixture, at least 6x teeth need to be tighten, fix the M3 screw to prevent the hook loosening.

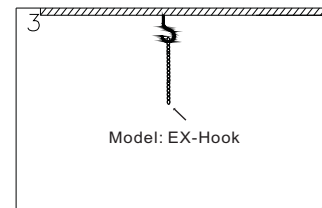

3. Drill 1 expansion screw hole and install it, and hang the chain as shown in Fig.3.

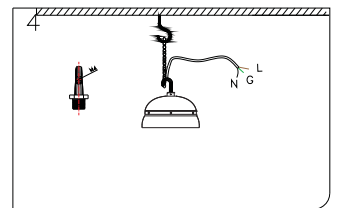

4. Connect black cable to L, Connect White cable to N, Connect green cable to grounding.

Stanchion Mounting

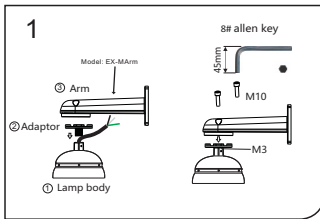

1. Tighten part 2 and assembly 1, and fix the M3 screw, install arm to the adaptor, tighten the M10 via 8# allen key.

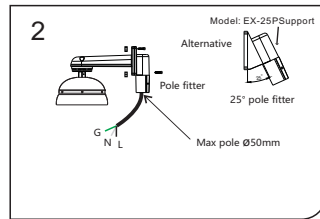

2. Install the pole fitter with arm via 4x M8 screws, the max suitable pole diameter 50mm, the alternative 25 degree pole fitter.

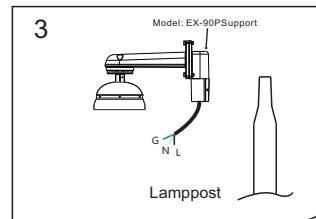

3. Contact the cable to AC wire, black one contact to live wire, white one contact to null wire, green one contact to grounding.

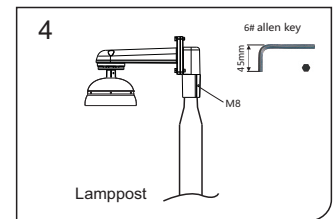

4. Slip the fitter to the lamppost and tighten M8 inner hexagonal screw.

Wall Mounting to junction box

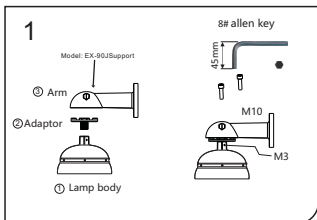

1. Tighten part 2 and assembly 1, and fix the M3 screw, install arm to the adaptor, tighten the M10 via 8# allen key.

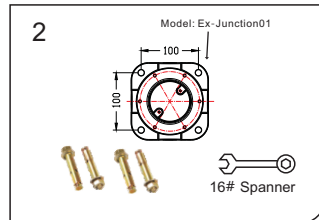

2. Drill 4x Ø10mm holes Install the junction box to the wall via M10 expanded screw.

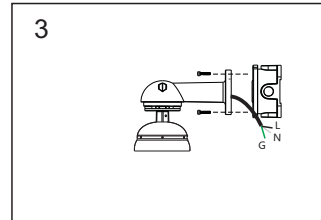

3. Contact the AC wire to power system, black one to Live wire, white one to Null wire, green one to grounding.

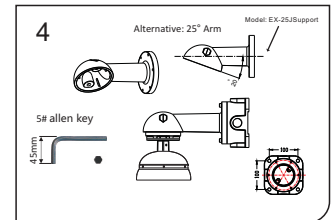

4. Tighten 6 x screws between arm and junction box, turn on the power to test the luminaires is work.

Accessories



- Model: Ex-Junction01
Name: Junction Box
Material: Aircraft Aluminum A383



- Model: EX-Hook
Name: Installation Hook
Material: Aircraft Aluminum A383



- Model: Ex-Conduit01
Name: Metal Conduit
Material: Stainless Steel and Aluminum



- Model: EX-WPipe
Name: Winding Swing Pipe
Material: Iron with Power Coating



- Model: EX-SPipe
Name: Winding Swing Pipe
Material: Iron with Power Coating



- Model: Ex-D01
Name: Pendant Direction Adapter
Material: Aircraft Aluminum A383



- Model: EX-MArm
Name: Surface Mounting Arm
Material: Aircraft Aluminum A383



- Model: EX-25PSupport
Name: 25 Degree Pole Support
Material: Aircraft Aluminum A383



- Model: EX-90PSupport
Name: 90 Degree Pole Support
Material: Aircraft Aluminum A383



- Model: Ex-90JSupport
Name: 90° Arm to Junction box
Material: Aircraft Aluminum A383



- Model: Ex-25JSupport
Name: 25° Arm to Junction box
Material: Aircraft Aluminum A383



- Model: Ex-DArm
Name: Direct Mounting Arm
Material: Aircraft Aluminum A383



- Model: Ex-Chain
Name: Pendant Chain
Material: Stainless Steel S30400